



I always insist on quality



WAKÜ
Brilliant. Original.

The original makes the difference



Maintenance-free WAKÜ quality: rugged stainless steel pins reliably and visibly lock the sturdy, corrosion-proof aluminium hinges.



8 special rivets through the stringers ensures an extremely rigid joint with the hinge.

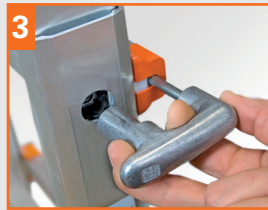

Solid, ergonomically shaped aluminium height adjusters guarantee easy and absolutely safe locking of the required ladder height.



Four-folded rung ends remain positively joined to stringers even in heavy-duty use.



Maximum non-slip effect while also protecting the flooring: large corrugated hard rubber foot pads are riveted to the ladder stringers.

Everything points to WAKÜ

Enjoy the benefits of the ultra-versatile WAKÜ telescopic ladder:

- Double ladder: height-adjustable, rung by rung
- Single extending ladder: extends to almost four times its transport length
- Step ladder: with adjustable offset to cope with height differences in stairwells and on gradients
- Space-saving design for transport and storage

WAKÜ telescopic ladders are manufactured from high-quality materials with convincing attention to detail and are extremely easy to handle. Their tapering design ensures maximum stability in any application.

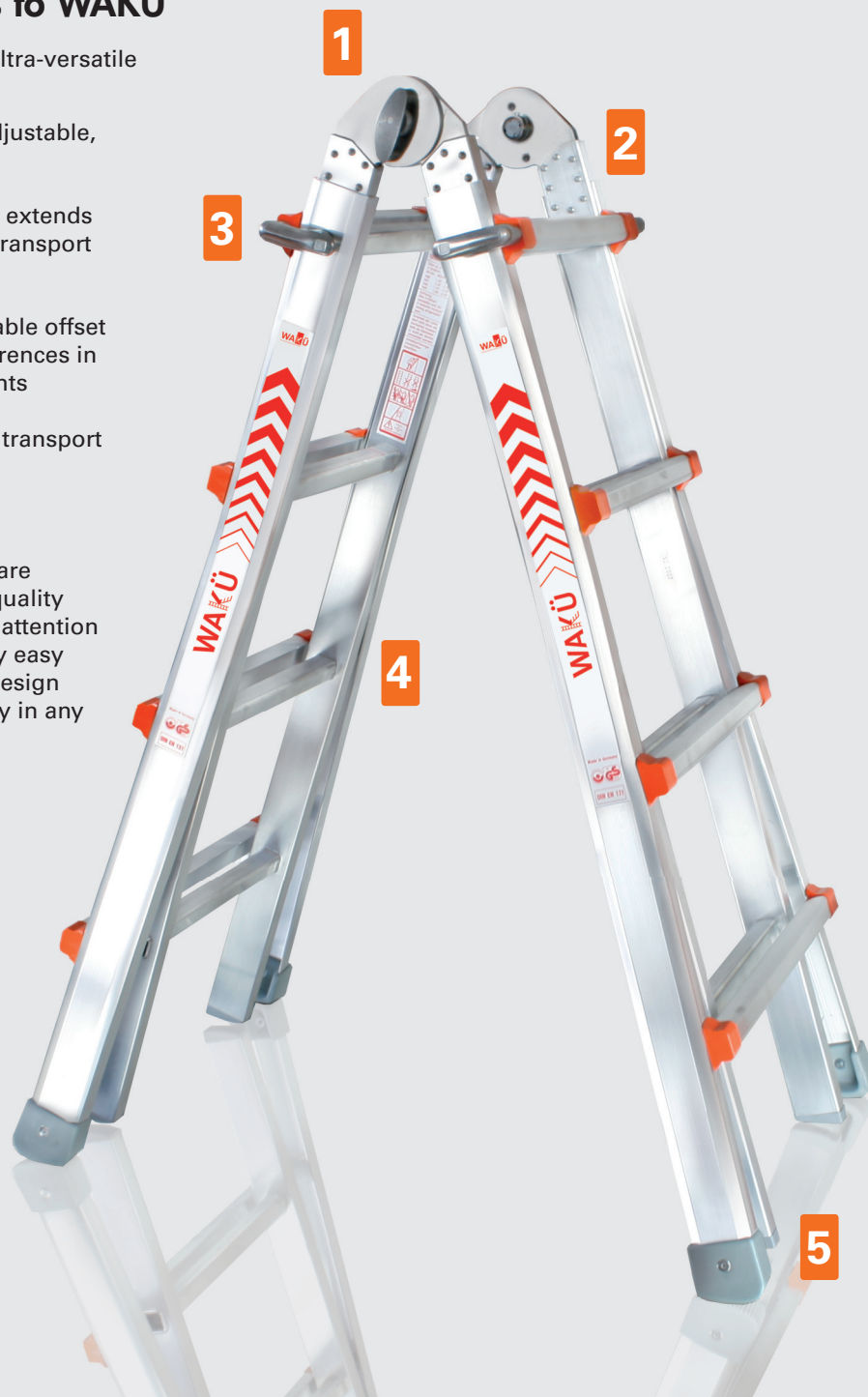

Up to any challenge



WAKÜ telescopic ladders:	Art. No. 100	Art. No. 101	Art. No. 102	Art. No. 103
Transport length: (storage size)	1,02 m	1,29 m	1,57 m	1, 85 m
Weight	10 kg	13 kg	16 kg	20 kg
Double ladder: height-adjustable, from the top rung level:	3-5 rung 1,34 m	4-7 rung 1,86 m	5-9 rung 2,40 m	6-11 rung 2,92 m
Single extending ladder: height-adjustable, from maximum ladder length:	6-10 rung 3,10 m	8-14 rung 4,20 m	10-18 rung 5,30 m	12-22 rung 6,40 m
Step ladder:	all 4 models can be used as offset ladders on steps/stairs and on gradients.			

Universal - the WAKÜ telescopic ladder

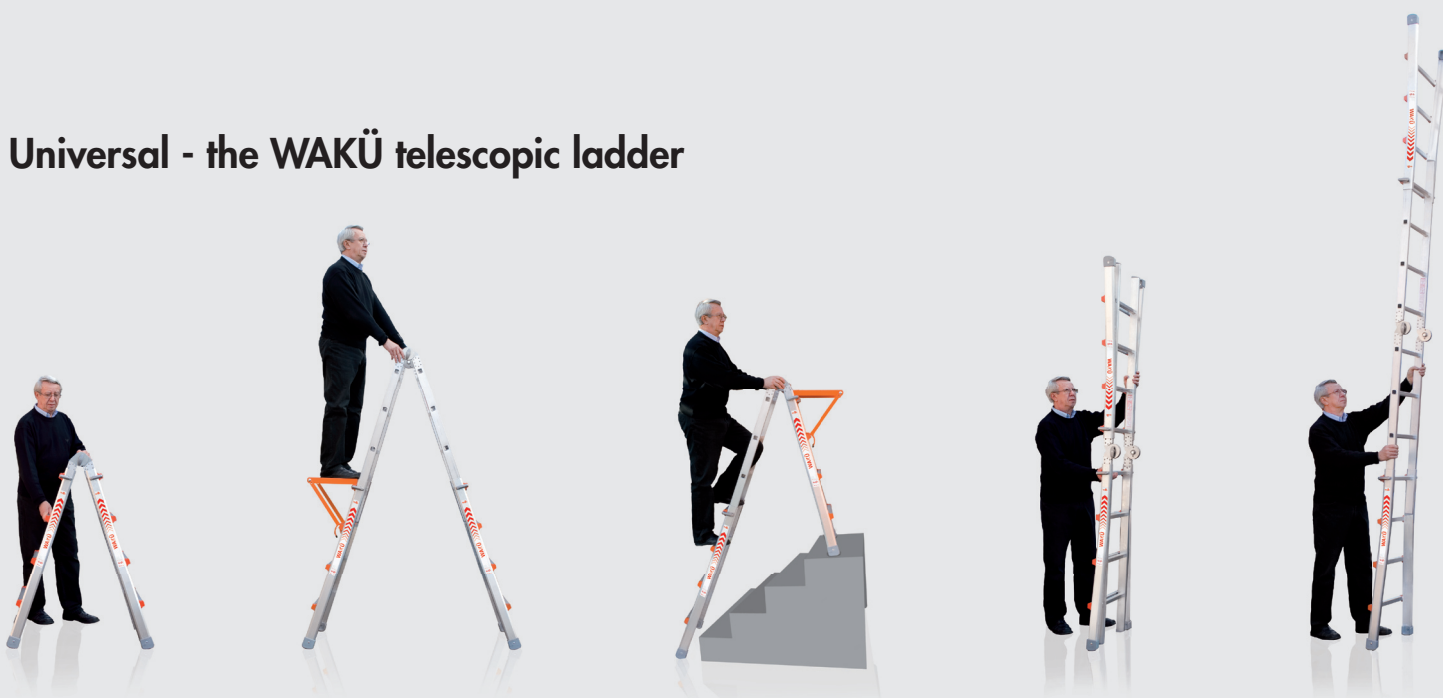

Accessories for WAKÜ telescopic ladder

enwkt0308



A Hook-on platform (Art. No. 104)

The platform provides a comfortable, safe standing area, or can be used as a shelf for buckets and tools.

It hooks onto any rung, and is easily pushed inside for the user to climb past.

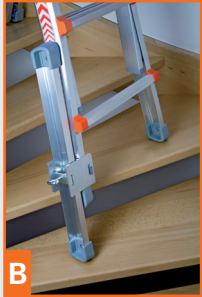

B Stringer extension (Art. No. 105)

Continuously height-adjustable, for use of the ladder on a spiral staircase or with a single ladder on uneven ground.



C Wall stand-off (Art. No. 106)

Includes a practical tool grid. Telescopic adjustment of wall stand-off distance. Spring clips for quick fitting.

The stand-off makes it easier to work while standing on the upper rungs.

D Ground spikes (Art. No. 109)

The screw-fit spikes provide ideal grip for your WAKÜ telescopic ladder on soft ground, including lawns.

E Ladder apex (Art. No. 110)

The ladder apex allows you to rest your WAKÜ telescopic ladder directly on a window frame.



F Extension (Art. No. 112)

In those situations where you are unable to lean your WAKÜ telescopic ladder against a support, the extension provides valuable added working height.

G Telescopic platform (Art. No. 123)

Aluminium platform, continuously extendable to almost double the retracted size. Sturdy, non-slip, lighter than a wooden platform and precisely adjustable to any required length up to the maximum.

Length: 2.04 m – 3.50 m

Width: 0.28 m

Weight: 13 kg

